

## DUST CAP

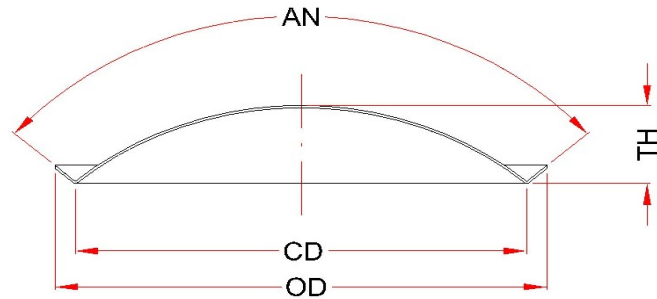

\* Dimension in mm

PART NO.	OD	CD	TH	AN	WEIGHT (g)	MATERIAL	SHAPE
DC-022-07	22.0	-	4.50	130	0.1	cloth	Dome
DC-022-08	21.0	-	5.50	-	0.17	Foam	Dome
DC-025-01	25.0	23.0	11.40	105	0.165	cloth	Dome
DC-028-01(1)	28.6	27.5	5.60	-	0.13	Paper	Dome
DC-030-06	29.7	-	6.20	-	0.15	Paper	Dome
DC-034-01	34.0	31.5	8.00	123	0.185	Paper	Dome
DC-034-05	34.0	31.5	8.00	123	0.185	Paper	Dome
DC-034-09	33.5	-	2.40	109	0.3	Paper	concave
DC-037-04	37.0	-	7.40	113	0.3	paper	Dome
DC-045-07	45.0	40.0	9.90	99	0.4	paper	Dome
DC-045-08	45.0	41.5	9.80	121	0.5	Paper	Dome
DC-048-01	48.0	-	4.70	-	0.8	Paper	concave
DC-050-04	50.0	-	4.60	-	0.4	Paper	concave
DC-051-08	51.0	47.8	9.20	127	0.6	Paper	Dome
DC-051-13	51.0	47.0	12.50	108	0.85	PP Dust Cap	Dome
DC-051-14	51.0	47.5	10.50	136	0.53	Paper	Dome
DC-054-02	54.0	50.0	10.00	108	0.5	Paper	Dome
DC-055-14	55.6	-	11.00	137	1	Paper	Dome
DC-055-15	55.6	50.0	11.00	106	1.2	Paper	Dome
DC-056-01	56.0	52.6	5.80	-	1.5	Paper	concave
DC-057-01	57.0	54.4	19.00	120	0.75	Paper	Dome
DC-057-03	57.0	-	4.40	-	1	Paper	concave
DC-060-01	60.0	-	7.50	-	0.8	Paper	concave
DC-060-13	60.0	56	13.00	110	1.0	Paper	Concave
DC-065-14	65.5	59.8	13.80	107	6.00	Paper	Dome
DC-065-15	65.0	60.0	13.00	107	2.00	Paper	Dome

PART NO.	OD	CD	TH	AN	WEIGHT (g)	MATERIAL	SHAPE
DC-065-22	65.0	60.0	13.00	107	2	Paper	Dome
DC-065-29	65.0	60.0	9.40	113	0.85	Paper	Dome
DC-070-05	70.0	-	8.60	-	4.5	Paper	concave
DC-071-01	71.0	69.4	20.30	106	1.85	Paper	Dome
DC-071-02	71.5	66.0	9.00	-	2.6	Paper	Dome
DC-080-13	80.0	-	5.50	-	2.5	Paper	Concave
DC-082-04	82.0	76.0	14.30	110	1.3	Paper	Dome
DC-082-06	82.0	76.0	14.30	110	1.8	Paper	Dome
DC-085-05	85.0	78.0	15.00	107	3	Paper	Dome
DC-087-01	87.0	85.3	21.20	122	2.6	Paper	Dome
DC-090-02	90.0	47	12.50	99	4.4	Foam	Dome
DC-092-03	92.0	84.0	21.50	118	2.7	Paper	Dome
DC-092-04	92.0	84.3	21.10	118	2	Paper	Dome
DC-100-04	101.0	95	17.50	115	2.5	Paper	Dome
DC-105-01	105.0	99.0	13.00	97	3.1	Paper	Dome
DC-105-08	105.0	100.0	10.30	-	7	Paper	concave
DC-106-01	106.0	100.0	21.00	113	5	Paper	Dome
DC-110-01	110.0	104.0	17.00	111	8.5	Paper	Dome
DC-110-02	110.4	-	24.80	-	3.9	Paper	Dome
DC-110-03	110.0	-	25.00	-	3.6	Paper	Dome
DC-110-04	110.0	104.7	20.00	124	2.8	Paper	Dome
DC-110-05	110.0	104.7	20.00	124	3.1	Paper	Dome
DC-113-01	112.5	-	25.00	-	3	Paper	Dome
DC-115-12	115.0	108.0	21.30	122	5.8	Paper	Dome
DC-115-13	115.0	108.0	21.00	122	3.5	Paper	Dome
DC-115-14	115.0	108.0	17.00	103	3.2	Paper	Dome
DC-115-15	115.0	-	16.50	-	4	Paper	Dome
DC-115-16	115.0	110.5	20.60	104	3.7	Paper	Dome
DC-117-01	117.0	109.7	25.50	106	4	Paper	Dome
DC-120-02	120.0	-	11.00	-	8	Paper	concave
DC-130-04	130.0	122.0	18.80	116	7.5	Paper	Dome
DC-134-02	134.0	128.0	16.50	105	6.3	Paper	Dome
DC-134-03	133.4	-	34.00	-	7	Paper	Dome
DC-135-05	132.5	-	34.00	-	5.3	Paper	Dome
DC-140-01	139.7	-	37.50	-	7.5	Paper	Dome
DC-145-01	145.0	138.0	22.7	130	11.5	Paper	Dome
DC-150-03	150.0	138.0	22.40	130	7.5	Paper	Dome
DC-150-04	150.0	138.0	22.50	130	9.0	Paper	Dome
DC-152-01	152.0	-	25.44	-	13.0	Paper	Dome

PART NO.	OD	CD	TH	AN	WEIGHT (g)	MATERIAL	SHAPE
DC-155-03	154.0	152.0	32.50	108	8.5	Paper	Dome
DC-160-01	159.5	-	25.00	-	12	Paper	concave
DC-165-02	165.0	-	30.40	-	22.5	Paper	Dome
DC-170-01	170.0	-	32.80	-	20.6	Paper	Dome
DC-170-02	170.0	-	20.45	-	9	Paper	Dome
DC-187-01	187.0	177.5	26.00	106	18	Paper	Dome
DC-179-01	179.0	173.0	33.00	110	14	Paper	Dome
DC-200-01	202.0	192.0	35.40	100	22.5	Paper	Dome